

# मालती रेसिडेंसी

फेस-॥

# MALTI

# Residency

PHASE II

A Project of Shops  
& HIG/MIG Flats

दुकाने व प्रकोष्ठ भवन

राजेंद्र नगर  
रेलवे कोच फैक्ट्री के पास भोपाल

Rajendra Nagar,  
Near Railway Coach Factory, Bhopal

हो गया साकार अपने सपनों का आकार...



# MALTI



# Residency PHASE II

RAJENDRA NAGAR, NEAR RAILWAY COACH FACTORY, BHOPAL

# MALTI



# Residency PHASE II

RAJENDRA NAGAR, NEAR RAILWAY COACH FACTORY, BHOPAL

## Ground Floor Shops Plan

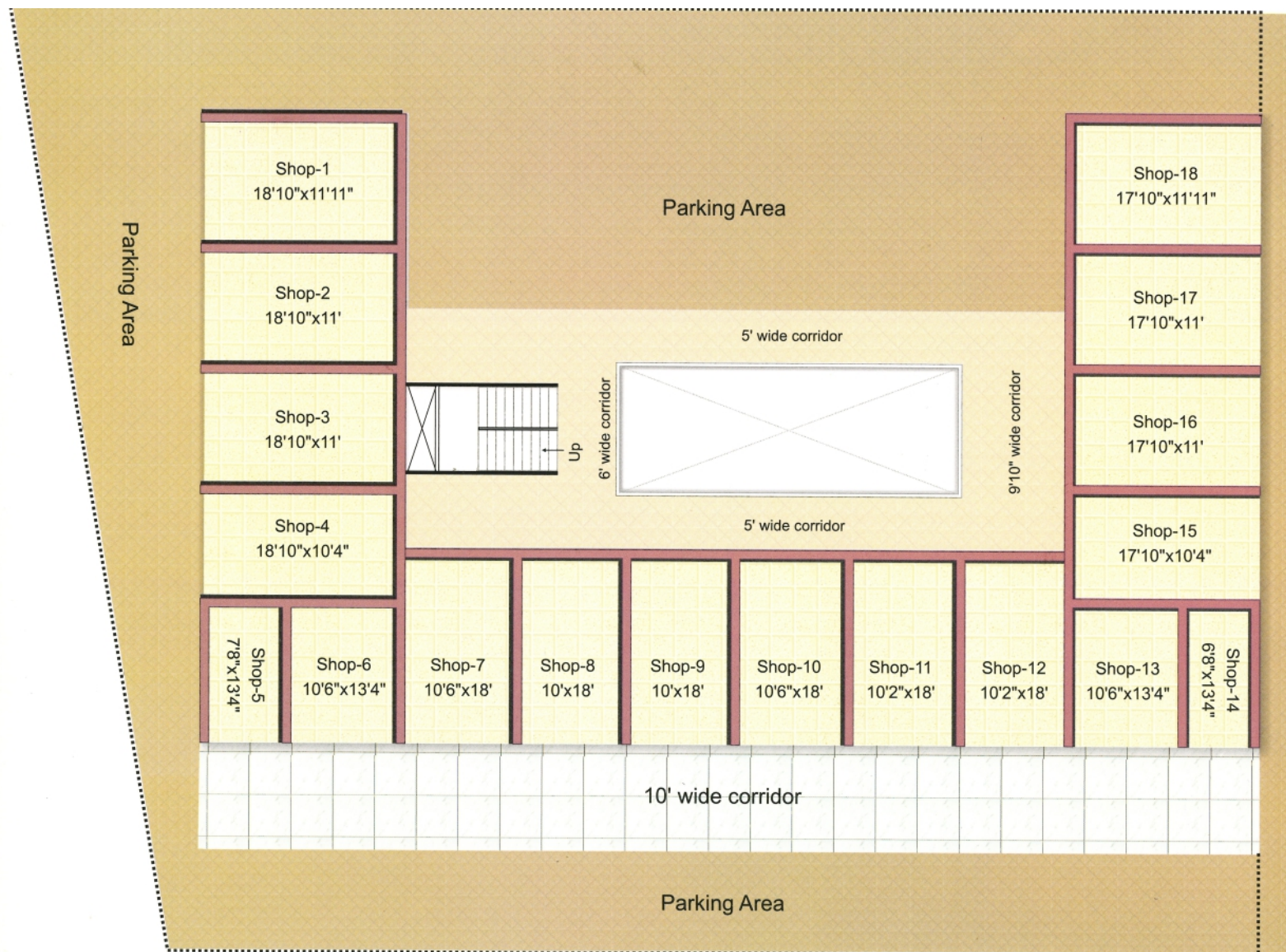

## First & Second Floor Plan

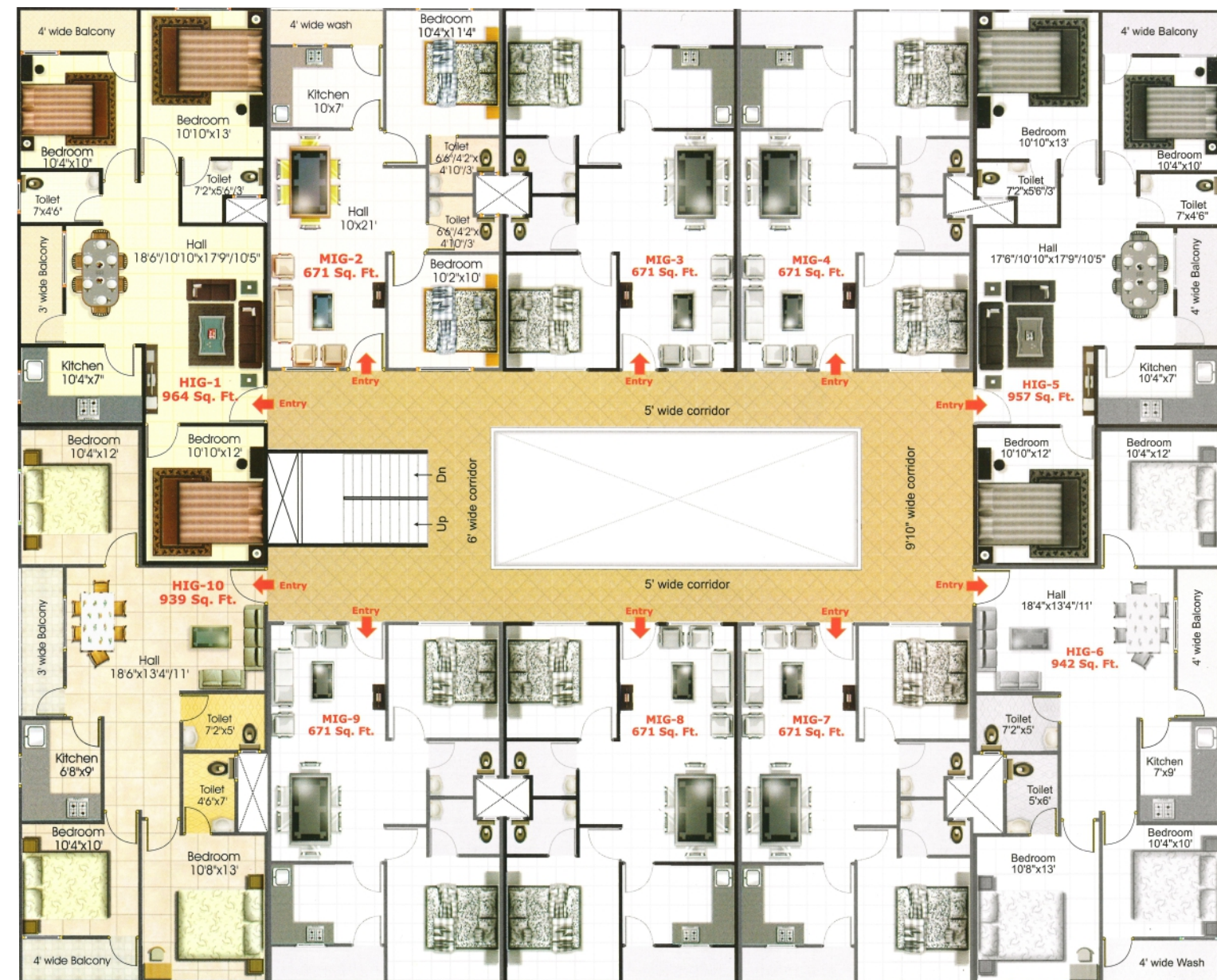

## Specifications:

<b>Structure</b>	: RCC Framed
<b>Flooring</b>	: 100% Ceramic in drawing room, bed room, kitchen & toilet. Parking shall have mosaic tiles or paving blocks
<b>Toilet</b>	: Ceramic tiles dado up to 6' height
<b>Kitchen</b>	: White Marble Platform, Steel sink and dado upto 24" height
<b>Doors &amp; Windows</b>	: Door frame of pressed steel section, Door panels shall be flush door, window frames of pressed steel section or Aluminum section window panels with glazing, Toilet ventilators in MS pipe or Aluminum frame with glass louvers
<b>Electrical</b>	: Concealed copper wiring
<b>Plumbing</b>	: Concealed water supply line, separate over head tank of 500 liters. ISI marked sanitary fitting, PPR and GI pipes of perfect guage
<b>Water Supply</b>	: 1/2 inch drinking water connection shall be provided from over head tank/bore well
<b>Finishing</b>	: Exterior emulsion on outside face and oil bound distemper on inside face, grills and doors shall be oil painted
<b>Wall</b>	: 4" thick Brick Masonary



अपनी जीवन शैली  
को एक नया आकर दें



**MULTI HOMES** Builders & Developers

Corporate office : F2/59C, Ishan Indra Bhawan, Near Jubilee Gate, Indrapuri, BHEL, Bhopal

📞 77709 50092, 93998 98960, 98260 98993